

DRUGSWAB™

Follow the easy instructions below:

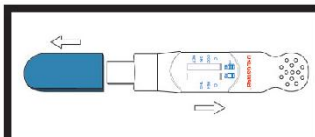

Step 1:

Carefully remove the blue cap by holding the sides and pull gently. This will expose the collection pad.

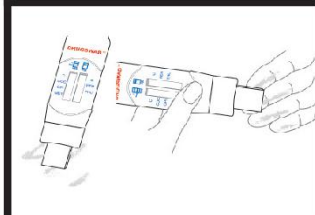

Step 2:

a. For drug residue on suspected surface: Wipe the suspected surfaces with collection pad by pushing both side of pad flat on surface

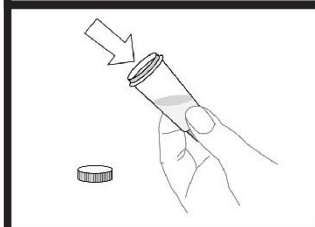

Step 3:

b. For drug powder or tablet or plant, put small amount of suspected solid into the buffer vial, shake 15-30 seconds.

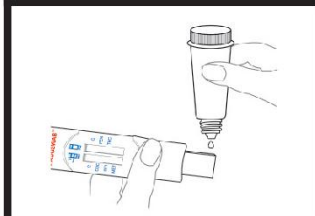

Step 4:

add ~20- drops of buffer onto collection pad or insert collection pad into buffer vial until fluid show up in the window area.

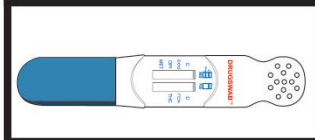

Step 5:

Lay the device on a flat surface and read results in approximately 3 minutes. Do not read results after 20 minutes.

Control Line
Test Line



Positive



Negative



Invalid



Read Test Result: NO C line means the TEST is INVALID
C line and No Line next to specific Drug, means POS for that drug.
C line and Line next to specific drug, means Neg for that drug.

Visit www.ostsus.com for more information.

On-Site Testing Specialists
1-866-833-2101